

MALL OF İSTANBUL

HIGH

RESIDENCE

KAT PLANLARI / FLOOR PLANS

**EN İYİNİN EN İYİSİ MALL OF İSTANBUL'DA
HIGH RESIDENCE İLE 5 YILDIZLI BİR YAŞAMA ve
YATIRIMA DAVETLİSİNİZ...**

AVM, residence ve ofisleri ile Türkiye'nin en büyük karma kullanım projesi Mall of İstanbul'un otel, convention center ve residence'dan oluşan 2. etabında sizleri ayrıcalıklı bir yatırıma davet ediyoruz. Dünyaca ünlü Hilton markası ile 25 katlı tek bir kule içinde projelendirilen Mall of İstanbul High Residence, eşsiz lokasyonu, lüks mimarisi, yaşamı sanata dönüştüren kusursuz detayları ile ayrıcalıklı bir yaşam vaadi sunuyor.

A 5-STAR LIFESTYLE: MALL OF İSTANBUL HIGH RESIDENCE

You are invited to a privileged investment opportunity in the second phase of Turkey's largest mixed use project Mall of İstanbul which consists of a hotel, convention center and residence. Mall of İstanbul High Residence, located in the same 25-floor tower where Hilton hotel is, offers you a privileged lifestyle in a unique location with its luxurious architecture and perfect details that transform life into art.





MALL OF İSTANBUL
HIGH
RESIDENCE

Hilton
MALL OF İSTANBUL

of Istanbul

Mall of Istanbul

CONVENTION
CENTER

HIGH RESIDENCE

Hilton

Mall of İstanbul High Residence'da 7 gün 24 saat Hilton Standartlarından yararlanabilirsiniz...

Restaurant, cafe, spa, fitness center hizmetlerine bir asansör ile ulaşabilecek, Mall of İstanbul'un alışveriş, kültür, sanat ve eğlence dolu dünyasını doyasıya yaşayabileceksiniz. 35 ayrı milletten yatırımcısı bulunan Mall of İstanbul'un son residence bloğu olan High Residence'da 80 m²'den başlayan ve 679 m²'ye kadar değişen büyüklüklerde, 1+1'den 5+1'e kadar farklı daire seçenekleri sunuluyor. İstanbul Havalimanı'na yakınlığı ve 2021 yılında açılacak M9 Ataköy-İkitelli metro hattına direkt bağlantısı ile İstanbul'un her noktasına kolaylıkla ulaşabileceksiniz. Türkiye'nin en büyük yerli gayrimenkul yatırım ortaklığı şirketi Torunlar GYO güvencesiyle hayata geçirilen Mall of İstanbul High Residence ile siz de 5 yıldızlı bir yaşamın ve yatırımın ayrıcalığını yaşayın...



BENZERSİZ
LOKASYON



METRO
BAĞLANTISI



İSTANBUL HAVALİMANI
15 DAKİKA



LÜKS
MİMARİ



KANAL İSTANBUL
5 DAKİKA



MALL OF İSTANBUL'UN
350 MAGAZASINA BAĞLANTI

Using an elevator, you will have the access to the restaurant, cafe, spa and fitness center services of Mall of İstanbul High Residence 24 hours a day..

7 days a week, and you will be able to make the most of Mall of İstanbul's world full of shopping, culture, art and entertainment. In High Residence, the last residence block of Mall of İstanbul which has investors of 35 nationalities, different apartment options are offered, with areas ranging from 80 to 679 square meters and different number of rooms from 1+1 to 5+1. With its closeness to İstanbul Airport and direct connection to the M9 Ataköy-İkitelli metro line, which will come into service in 2021, you can easily reach every point of İstanbul. Take the advantage of the privileged 5-star lifestyle and investment with Mall of İstanbul High Residence, which was implemented by Turkey's biggest local real estate investment company Torunlar REIC.



UNIQUE
LOCATION



METRO
CONNECTION



15 MINUTES TO
İSTANBUL AIRPORT



LUXURIOUS
ARCHITECTURE



15 MINUTES TO
CANAL İSTANBUL



ACCESS TO MOI'S
350 STORES

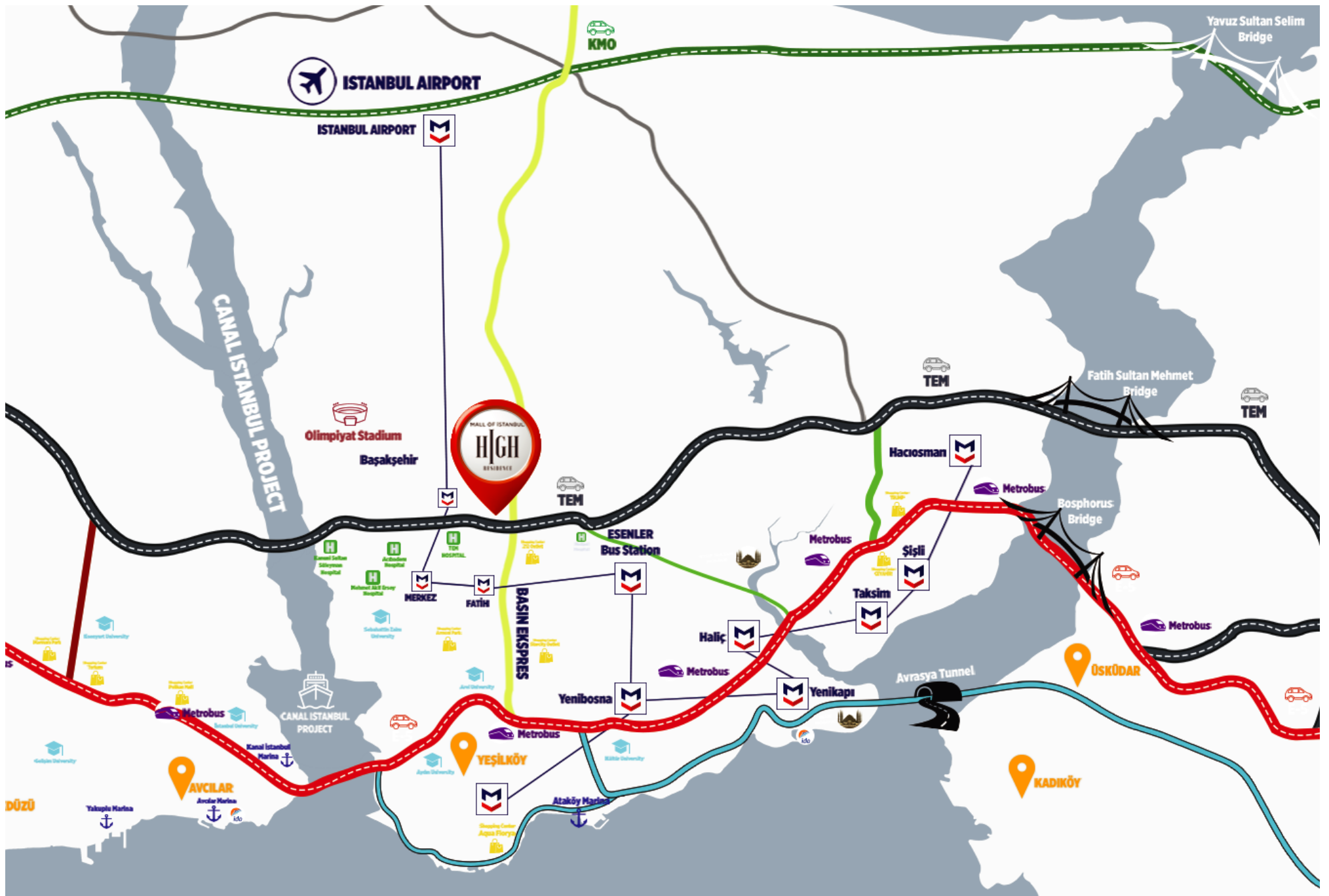



GÜNÜN HER ANI KUSURSUZ HİZMET

- Özel yönetim şirketleri ile benzersiz yönetim ve hizmet kalitesiyle yaşam çözümleri
- 7/24 tam konsiyerj hizmetleri
- Vale park
- Teknik ve acil hizmetler
- Temizlik hizmetleri
- Yemek servisi
- Akıllı ev sistemi
- Kuru temizleme
- Sauna
- Türk banyosu
- Loby

PERFECT SERVICE AT ANY MOMENT

- *Unique management with private management companies and living solutions with its service quality*
- *7/24 full concierge services*
- *Valet parking*
- *Technical and emergency services*
- *Housekeeping services*
- *Catering service*
- *Smart home sysem*
- *Dry cleaning*
- *Sauna,*
- *Turkish Bath*
- *Loby*



1+1

1 ANTRE	5,12	m ²
2 SALON	14,97	m ²
3 MUTFAK	5,56	m ²
4 KAT BANYOSU	4,95	m ²
5 ÇAMAŞIR ODASI	0,63	m ²
6 YATAK ODASI	13,29	m ²
7 BALKON	7,56	m ²

Balkon Dahil Toplam Daire Alanı: 52,08 m²
Satış Brüt Alanı: 80,06 m²

1 ENTRANCE	5,55	m ²
2 KITCHEN	20,43	m ²
3 LIVING ROOM	5,27	m ²
4 BATHROOM	4,43	m ²
5 LAUNDRY ROOM	0,63	m ²
6 BEDROOM	5,11	m ²
7 BALCONY	6,92	m ²

Total Apartment Area including Balcony: 52,08 m²
Gross Sales Area: 80,06 m²

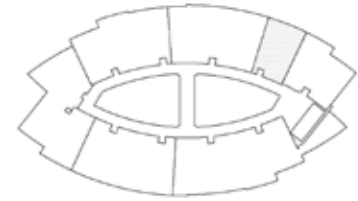
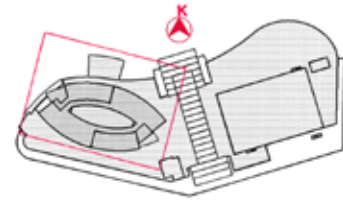
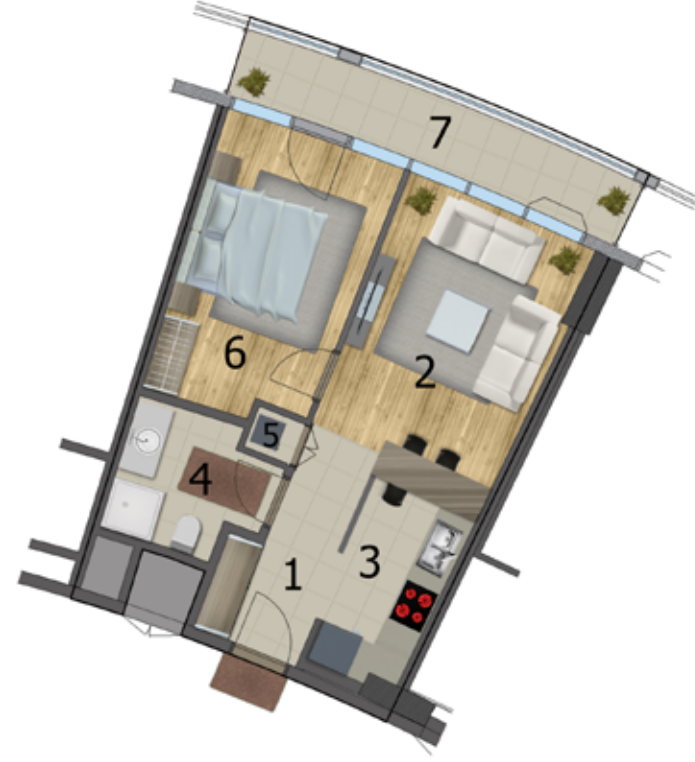

2+1

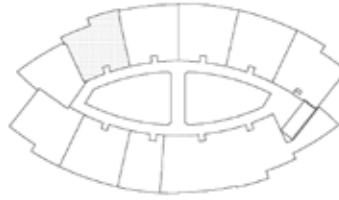
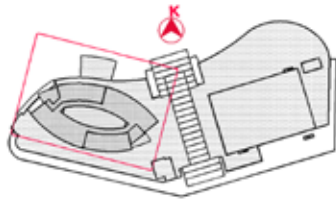

1 ANTRE	4,96	m ²
2 SALON	17,73	m ²
3 MUTFAK	3,96	m ²
4 BANYO	3,87	m ²
5 ÇAMAŞIR ODASI	1,15	m ²
6 KORİDOR	3,59	m ²
7 YATAK ODASI	13,47	m ²
8 EBEVEYN YATAK ODASI	16,61	m ²
9 EBEVEYN BANYO	3,84	m ²
10 BALKON	5,67	m ²

Balkon Dahil Toplam Daire Alanı: 72,76 m²
Satış Brüt Alanı: 115,16 m²

1 ENTRANCE	4,96	m ²
2 LIVING ROOM	17,73	m ²
3 KITCHEN	3,96	m ²
4 BATHROOM	3,87	m ²
5 LAUNDRY ROOM	1,15	m ²
6 CORRIDOR	3,59	m ²
7 BEDROOM	13,47	m ²
8 MASTER BEDROOM	16,61	m ²
9 PARENTS' BATHROOM	3,84	m ²
10 BALCONY	5,67	m ²

Total Apartment Area including Balcony: 72,76 m²
Gross Sales Area: 115,16 m²

3+1

1 ANTRE	4,33	m ²
2 SALON	21,66	m ²
3 MUTFAK	4,71	m ²
4 BANYO	4,33	m ²
5 ÇAMAŞIR ODASI	1,00	m ²
6 KORİDOR	4,76	m ²
7 YATAK ODASI 1	9,26	m ²
8 YATAK ODASI BANYO	2,68	m ²
9 YATAK ODASI 2	11,35	m ²
10 EBEVEYN YATAK ODASI	13,29	m ²
11 EBEVEYN BANYO	3,77	m ²
12 BALKON 1	6,41	m ²
13 BALKON 2	6,79	m ²

Balkon Dahil Toplam Daire Alanı: 94,34 m²
Satış Brüt Alanı: 154,41 m²

1 ENTRANCE	4,33	m ²
2 LIVING ROOM	21,66	m ²
3 KITCHEN	4,71	m ²
4 BATHROOM	4,33	m ²
5 LAUNDRY ROOM	1,00	m ²
6 CORRIDOR	4,76	m ²
7 BEDROOM 1	9,26	m ²
8 PARENTS' BATHROOM	2,68	m ²
9 BEDROOM 2	11,35	m ²
10 MASTER BEDROOM	13,29	m ²
11 PARENTS' BATHROOM	3,77	m ²
12 BALCONY 1	6,41	m ²
13 BALCONY 2	6,79	m ²

Total Apartment Area including Balcony: 94,34 m²
Gross Sales Area: 154,41 m²



3+1

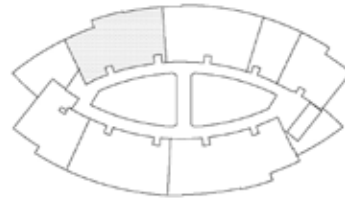
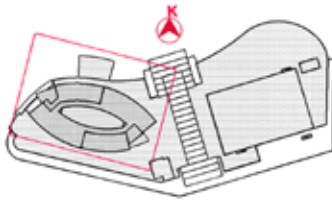

1 ANTRE	4,42	m ²
2 SALON	32,07	m ²
3 MUTFAK	9,60	m ²
4 MİSAFİR WC/BANYO	2,88	m ²
5 BANYO	4,70	m ²
6 ÇAMAŞIR ODASI	2,35	m ²
7 KORİDOR	4,47	m ²
8 HOL	4,11	m ²
9 YATAK ODASI 1	11,98	m ²
10 YATAK ODASI 2	12,09	m ²
11 EBEVEYN YATAK ODASI	17,72	m ²
12 EBEVEYN BANYO	5,14	m ²
13 BALKON	11,81	m ²

Balkon Dahil Toplam Daire Alanı: 123,34 m²
Satış Brüt Alanı: 195,91 m²

1 ENTRANCE	4,42	m ²
2 LIVING ROOM	32,07	m ²
3 KITCHEN	9,60	m ²
4 GUEST BATHROOM	2,88	m ²
5 BATHROOM	4,70	m ²
6 LAUNDRY ROOM	2,35	m ²
7 CORRIDOR	4,47	m ²
8 HALLWAY	4,11	m ²
9 BEDROOM 1	11,98	m ²
10 BEDROOM 2	12,09	m ²
11 MASTER BEDROOM	17,72	m ²
12 PARENTS' BATHROOM	5,14	m ²
13 BALCONY	11,81	m ²

Total Apartment Area including Balcony: 123,34 m²
Gross Sales Area: 195,41 m²

3+1

1 ANTRE	5,16	m ²
2 SALON	33,99	m ²
3 MUTFAK	11,67	m ²
4 MİSAFİR WC/BANYO	2,51	m ²
5 BANYO	5,89	m ²
6 ÇAMAŞIR ODASI	0,57	m ²
7 KORİDOR	8,41	m ²
8 YATAK ODASI 1	10,99	m ²
9 YATAK ODASI 2	10,40	m ²
10 EBEVEYN YATAK ODASI	17,47	m ²
11 EBEVEYN BANYO	5,26	m ²
12 BALKON	18,19	m ²

Balkon Dahil Toplam Daire Alanı: 130,51 m²
Satış Brüt Alanı: 201,06 m²

1 ENTRANCE	5,16	m ²
2 LIVING ROOM	33,99	m ²
3 KITCHEN	11,67	m ²
4 GUEST BATHROOM	2,51	m ²
5 BATHROOM	5,89	m ²
6 LAUNDRY ROOM	0,57	m ²
7 CORRIDOR	8,41	m ²
8 BEDROOM 1	10,99	m ²
9 BEDROOM 2	10,40	m ²
10 MASTER BEDROOM	17,47	m ²
11 PARENTS' BATHROOM	5,26	m ²
12 BALCONY	18,19	m ²

Total Apartment Area including Balcony: 130,51 m²
Gross Sales Area: 201,06 m²

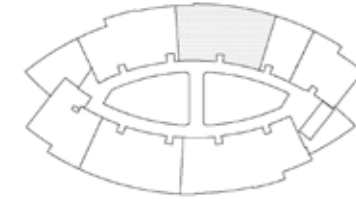
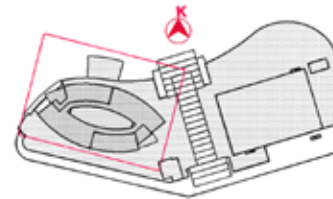
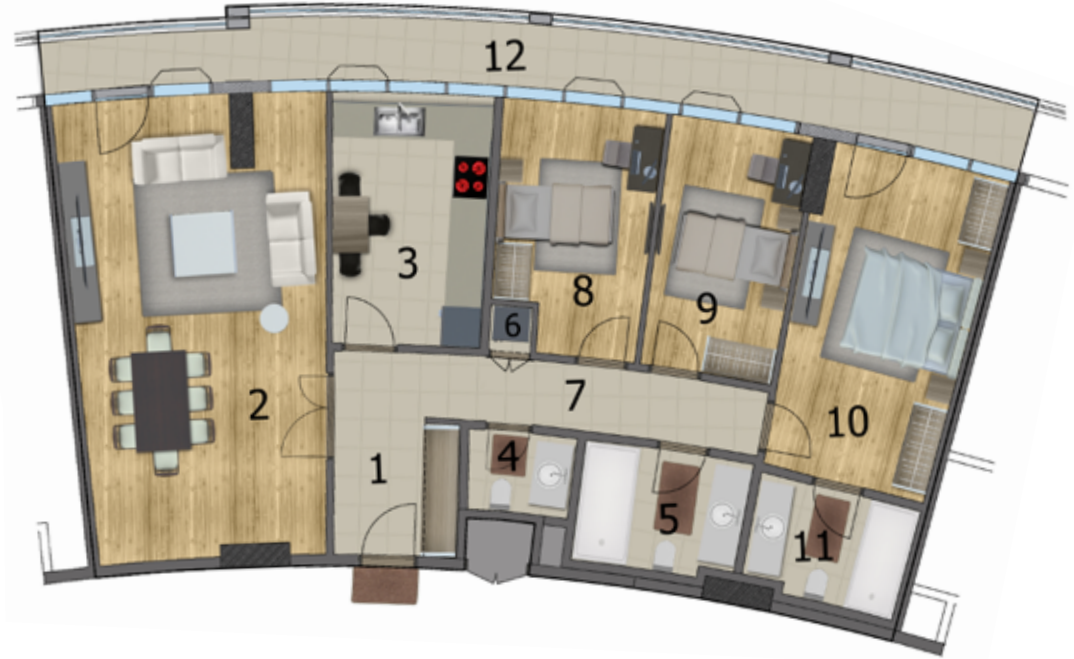

3+1



1 ANTRE	4,62	m ²
2 SALON	34,51	m ²
3 MUTFAK	9,39	m ²
4 MİSAFİR WC/BANYO	4,25	m ²
5 BANYO	4,87	m ²
6 ÇAMAŞIR ODASI	1,47	m ²
7 KORİDOR	8,08	m ²
8 YATAK ODASI 1	11,07	m ²
9 YATAK ODASI 2	12,30	m ²
10 EBEVEYN YATAK ODASI	18,56	m ²
11 EBEVEYN BANYO	6,34	m ²
12 BALKON	19,77	m ²

Balkon Dahil Toplam Daire Alanı: 135,23 m²
Satış Brüt Alanı: 206,69 m²

1 ENTRANCE	4,62	m ²
2 LIVING ROOM	34,51	m ²
3 KITCHEN	9,39	m ²
4 GUEST BATHROOM	4,25	m ²
5 BATHROOM	4,87	m ²
6 LAUNDRY ROOM	1,47	m ²
7 CORRIDOR	8,08	m ²
8 BEDROOM 1	11,07	m ²
9 BEDROOM 2	12,30	m ²
10 MASTER BEDROOM	18,56	m ²
11 PARENTS' BATHROOM	6,34	m ²
12 BALCONY	19,77	m ²

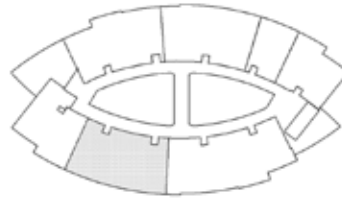
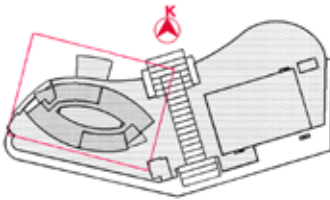

Total Apartment Area including Balcony: 135,23 m²
Gross Sales Area: 206,69 m²

4+1

1 ANTRE	10,02	m ²
2 SALON	42,19	m ²
3 MUTFAK	11,44	m ²
4 MİSAFİR WC/BANYO	4,75	m ²
5 BANYO	4,78	m ²
6 ÇAMAŞIR ODASI	0,87	m ²
7 KORİDOR	4,79	m ²
8 HOL	2,87	m ²
9 YATAK ODASI 1	12,18	m ²
10 YATAK ODASI 2	12,04	m ²
11 YATAK ODASI 3	13,49	m ²
12 EBEVEYN YATAK ODASI	27,32	m ²
13 EBEVEYN BANYO	4,82	m ²
14 BALKON	17,37	m ²

Balkon Dahil Toplam Daire Alanı: 168,63 m²
Satış Brüt Alanı: 261,70 m²

1 ENTRANCE	10,02	m ²
2 LIVING ROOM	42,19	m ²
3 KITCHEN	11,44	m ²
4 GUEST BATHROOM	4,75	m ²
5 BATHROOM	4,48	m ²
6 LAUNDRY ROOM	0,87	m ²
7 CORRIDOR	4,79	m ²
8 HALLWAY	2,87	m ²
9 BEDROOM 1	12,18	m ²
10 BEDROOM 2	12,04	m ²
11 BEDROOM 2	13,49	m ²
12 MASTER BEDROOM	27,32	m ²
13 PARENTS' BATHROOM	4,82	m ²
14 BALCONY	17,37	m ²

Total Apartment Area including Balcony: 168,63 m²
Gross Sales Area: 261,70 m²

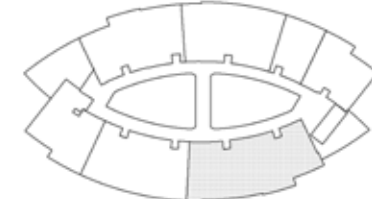
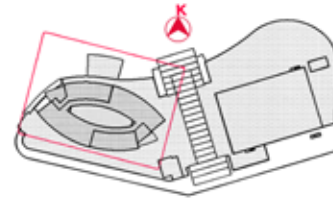

Örnek planlar dairenin bulunduğu blok kata göre alt yapıdan kaynaklanan farklılıklar gösterebilir. Yüklenici, projenin uygulaması sırasında teknik açıdan gerekli gördüğü değişiklikleri yapma hakkına sahiptir.

The sample plans may differ from the infrastructure depending on the block floor where the apartment is located. The Contractor shall have the right to make any technical changes he deems necessary during the implementation of the project.

www.mallofistanbulresidence.com

444 2 664